



Users Manual



Mac Developments - Australia

www.macdev.net

Info@macdev.net





Gladiator Version 04

Users Manual Version 2.10

Copyright Mac Developments Pty. Ltd. 2004

All rights reserved

No part of this document may be copied or reproduced in any form or by any means without the prior written consent of Mac Developments Pty. Ltd.

Notice is hereby given that this manual is part of the article owned in whole by Mac Developments Pt. Ltd., known as indicated in this manual and drawings. All rights of manufacture and reproduction of such articles or any part thereof are reserved by Mac Developments Pty Ltd. Neither said article nor any part thereof may be manufactured or reproduced without the written authorization from Mac Developments Pty. Ltd. All proprietary rights and information are the sole property of Mac Developments Pty. Ltd.

Statement of Liability

Mac Developments Pty. Ltd. Makes no warranties with respect to this documentation and disclaims any implied warranties of merchantability or fitness for a particular purpose. The information in this document is subject to change without notice. Mac Developments Pty. Ltd. assumes no responsibility for its resale or safe handling. Mac Developments Pty. Ltd. assumes no responsibility for physical injury or property damage resulting from its use.



MacDev 2004/5

Find us on the web at:

www.macdev.net

Email us at:

info@macdev.net

Australian Office:

Mac Developments
PO Box 584
Gymea, NSW
Australia 2227

ph: INT+612 9531 5055

fax: INT+6129531 5188

US distributor:

Gramps and Grizzly's Outpost
7203 Arlington Ave, Unit F
Riverside, CA 92503

ph: (909) 359-4859

Accessories

Use genuine macdev accessories for best results.

Rebuild Kit

The Gladiator rebuild kit contains all the parts that may commonly need replacing. This kit is a must for any serious toolkit.

Sonic ASA

The Sonic ASA is specifically designed to fit the Gladiator to popular paintball markers - designs currently available include:

- Angel LCD
- B2K/B2K2/DEFIANT
- Tribal
- AutoCocker

MacLine Kit

The Macline kit includes 3 fittings (1 straight, 1 fixed elbow and 1 swivel elbow) to ensure easy plumbing to any popular air/nitro system.

Introduction

The 04 Conquest is a fully balanced, enhanced flow 4th generation paintball regulator. The Gladiator is built from precision machined components manufactured on some of the most sophisticated computer controlled machinery in the world today.

Features

- Dual pressure, balanced regulation
- Optimised high flow seals
- High memory elastomer, abrasion resistant seal material
- Bottom adjustment with bottom inlet
- Harmonised motion piston system, with low maintenance features
- Easy rebuild design - fully user rebuildable
- Strengthened adjustment with stainless steel screw

Installation

Air Fitting Installation:

Your Gladiator inline reg comes ready to have an air fitting installed. To correctly install your air fitting follow these steps. NOTE: failure to follow these instructions may result in damage to your Gladiator – this is not covered under warranty!

Step 1: Unscrew the two halves of your Gladiator (by hand). NOTE: There is a white grease on the threads inside your Gladiator – do not wipe this off.

Step 2: Use a wrench to hold the Gladiator bottom works in place as you tighten the air fitting into place (as shown in figure 3). Do not over tighten the air fitting, and use a snug wrench on the Gladiator bottom works to prevent scratching. Now re-assemble your Gladiator and it is ready for use.

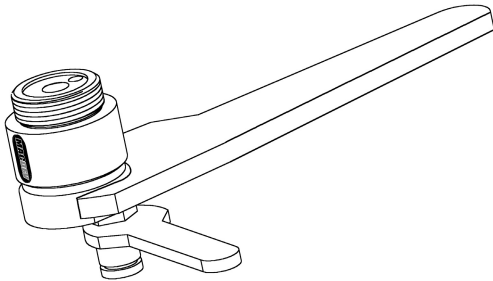

7. Slide the piston etc back into the gladiator topworks and screw the bottom and topworks back together.

NOTE: Keeping your piston clean and lubricated at all times is essential to keeping your Gladiator inline reg consistent over the Chronograph.

Seat

If your Gladiator seat is dirty or damaged, you will find problems such as creeping or inconsistency. If you experience this, you can degas the system and inspect the seat. If debris is found on the seat, you may clean it off using a clean q-tip. Then try the gladiator for performance to ensure that no lasting damage has been done. However, if you still experience inconsistency, you can remove the seat and use the underside instead.

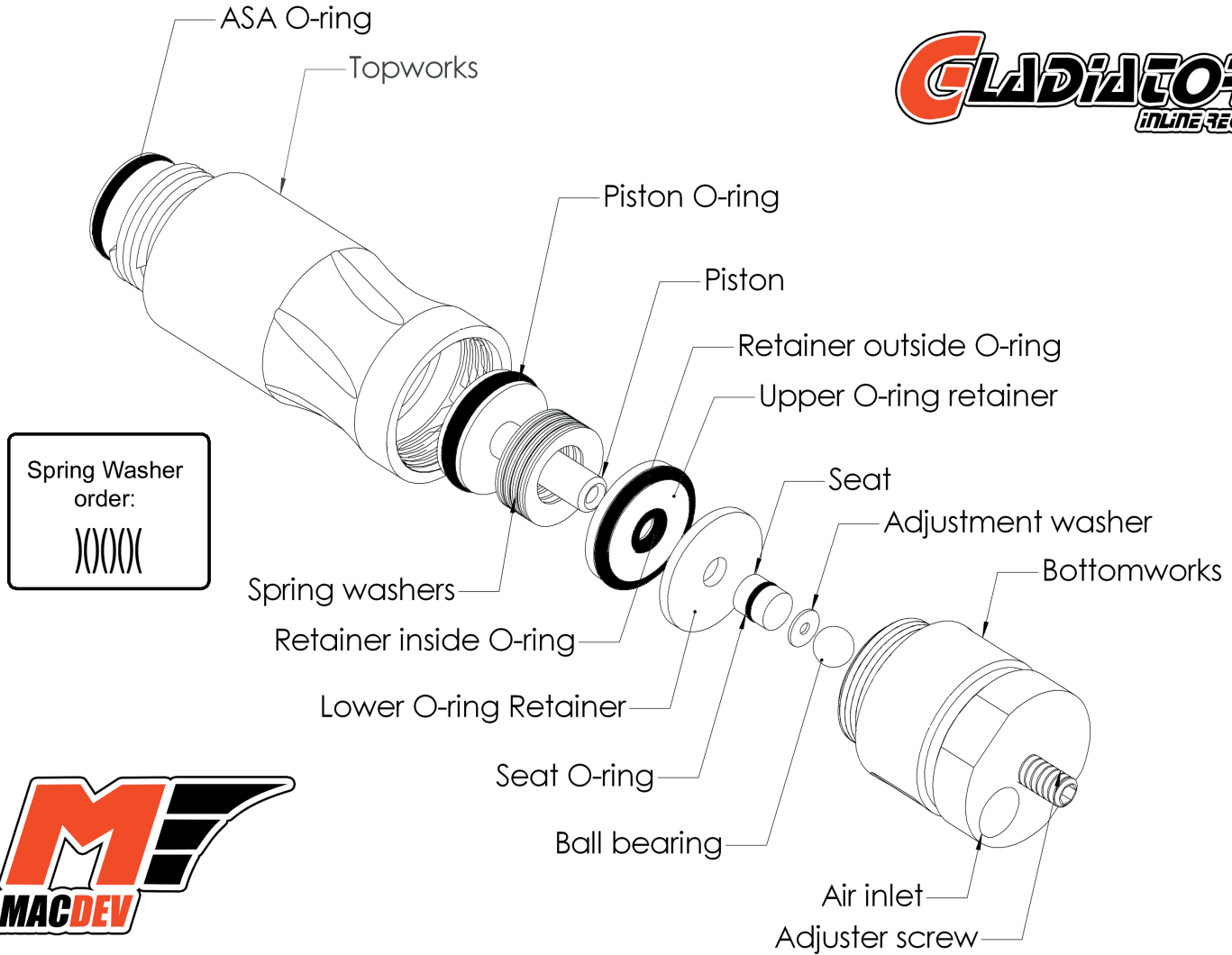

Maintaining your Gladiator

The 04 Gladiator is designed to require less maintenance than any previous Gladiator version. However, for optimal recharge and consistency, you should lubricate certain moving parts every 8,000 shots or so. These are detailed below.

Piston

The piston is continually sliding up and down inside the piston bore. This will eventually push the lubricant away from the o-ring. To remove the piston for lubrication:

1. Degas system of all pressurised gas and unscrew the bottomworks.
2. Place a rag on the tabletop and tap the gladiator topworks until the piston falls out. If it cannot be removed this way, you can push it out from the top. Separate the piston from the o-ring retainers and spring washers.
3. Clean the piston, o-rings and o-ring retainers of old grease using a clean rag, do not leave any lint or cotton strands on or between the o-rings. Re-apply Dow 33 to the o-rings.
4. Clean the piston bore using a Q-tip to remove all old grease.
5. Using a clean Q-tip, apply silicon grease to the piston bore. Do not over apply grease - all you need is a thin film.
6. slide the spring washers back onto the piston and lubricate the shaft with Dow 33. Now slide the o-ring retainers and o-rings back onto the shaft.

Connecting the Gladiator to your marker

The Gladiator will be accepted into all standard ASA adaptor threads. (for example: Cocker, LCD Angel, B2K, BKO, Cyborg)

Step 1: Lubricate o-ring and ASA threads with good quality silicon grease. DO NOT USE OIL.

Step 2: Screw Gladiator into ASA thread. Connect your air system to the fitting in the bottom of your Gladiator.

Step 4: Turn on air to the Gladiator reg. Wind the adjustment screw counter-clockwise to increase velocity and clockwise to decrease velocity. NOTE: always chronograph your marker after adjusting your regulator. Never chrono over 300fps.

Step 5: Put on your goggles, scream out "WHO'S YOUR DADDY?" and run onto the field.