

# 68 AUTOMAG *Classic*

## Exploded View

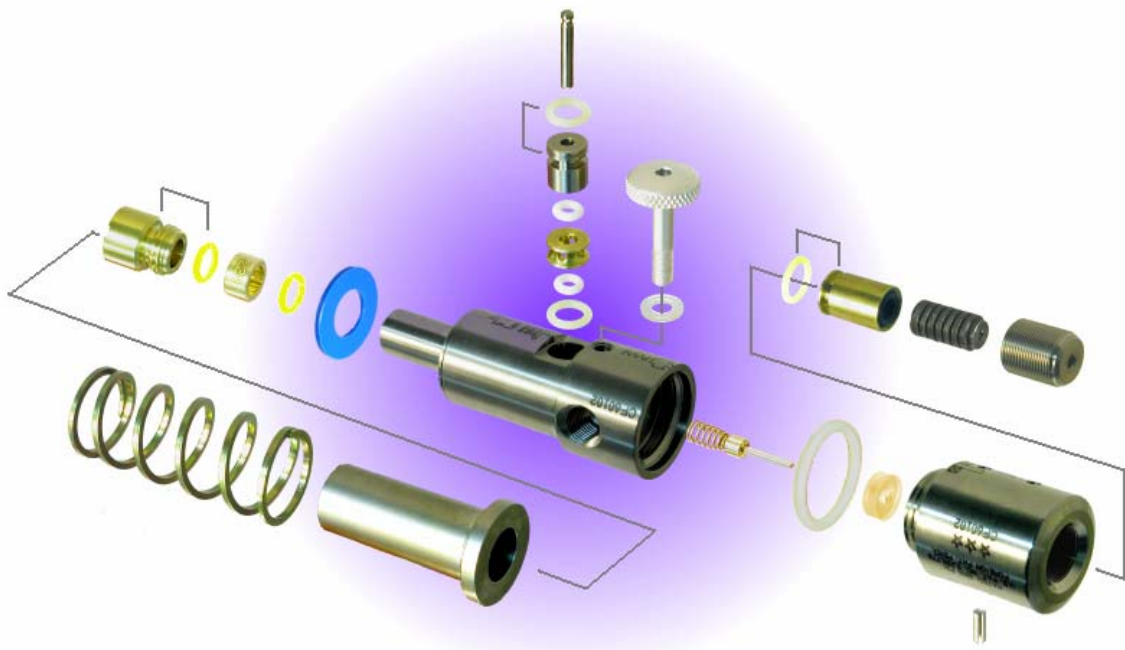

Click on any part for a larger view and description.

## Part #802 Bolt Foamieless



Bolts from AGD are made from hardened stainless for extra long life. They come in three different types:

1. Foamieless (hard nose): all stainless construction including the tip that pushes on the paintball. Get this one if you don't want to fool around with replacing stuff.
2. Foamie: a small foam rubber cushion is glued to the front of the bolt to softly push your paintballs into the barrel. Good if you play a lot in cold weather. The foamies do wear off and need to be replaced with superglue.
3. Superbolt: not shown here it is a different product (see link below). The Superbolt is for people who want the highest level of performance and the smoothest shooting marker possible. This bolt is about half the weight of the normal all stainless bolt shown here because it has a light weight delrin sleeve

[Order Online Now!](#)

[Back to Top](#)

## Part #798 Bolt Spring



The Bolt Spring fits all AGD markers regardless of age or type. They are made from very special square wire so they don't fold inside themselves when collapsed. Replace your old springs when they sag below the front of the bolt. Special honed bolt springs come with Superbolts to prevent premature wear. One spring also comes in the Parts Kit. If you need any o-rings the kit is a good value.

[Order Online Now!](#)

[Back to Top](#)

Part #432  
Field Strip Screw Assembly



The Field Strip Screw holds your valve in place. Comes with a small urethane rubber washer on the base to prevent it from vibrating out. Make sure you tighten it with a wrench.

[Order Online Now!](#)

[Back to Top](#)

Part #138  
On/Off Bottom



The On/Off Bottom is last part of the assembly to go into the valve.

[Order Online Now!](#)

[Back to Top](#)

## Part #139 On/Off Pin

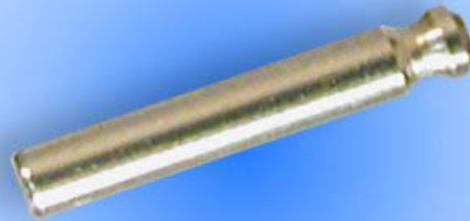

The On/Off Pin controls air flow in your marker. It is a critical precision component and should not be modified. It's hardened and chrome plated for extra long life.

[Order Online Now!](#)

[Back to Top](#)

## Part #141 On/Off Top



This part is one of several in the On/Off assembly. They all have names that start with On/Off to let you know where they go. This part can go in either way. Precision part, do not substitute with aftermarket items.

[Order Online Now!](#)

Back to Top

## Part #140 O-Ring Teflon - On/Off



Found in the On/Off assembly the Teflon O-Ring opens and seals with every shot. Replace this o-ring if you can pull and hold the trigger and you still hear leaking out the barrel. This o-ring is not rubber but more like plastic. Do not dent or abuse it.

[Order Online Now!](#)

[Back to Top](#)



## Part #123 O-Ring - Power Tube



This is the most common size o-ring in the marker. It's a good idea to have spares on hand. They come in the Parts Kit for a better value. Used in the Power Tube and the On/Off assembly.

[Order Online Now!](#)

[Back to Top](#)

Part# 113  
Regulator Piston O-ring



Two Reg Piston O-Rings are included in the Parts Kit or you can purchase them separately. Replace if you notice air leaking from the side vent hole in the regulator body.

[Order Online Now!](#)

[Back to Top](#)

Part #115  
O-Ring - Regulator Body

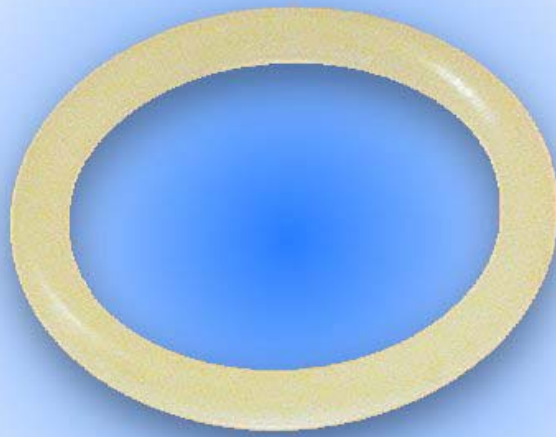

The Regulator Body O-Ring seals the two halves of the Valve Body together.  
Also included in the Parts Kit.

[Order Online Now!](#)

[Back to Top](#)

Part #781  
O-Ring - Power Tube Tip, RT

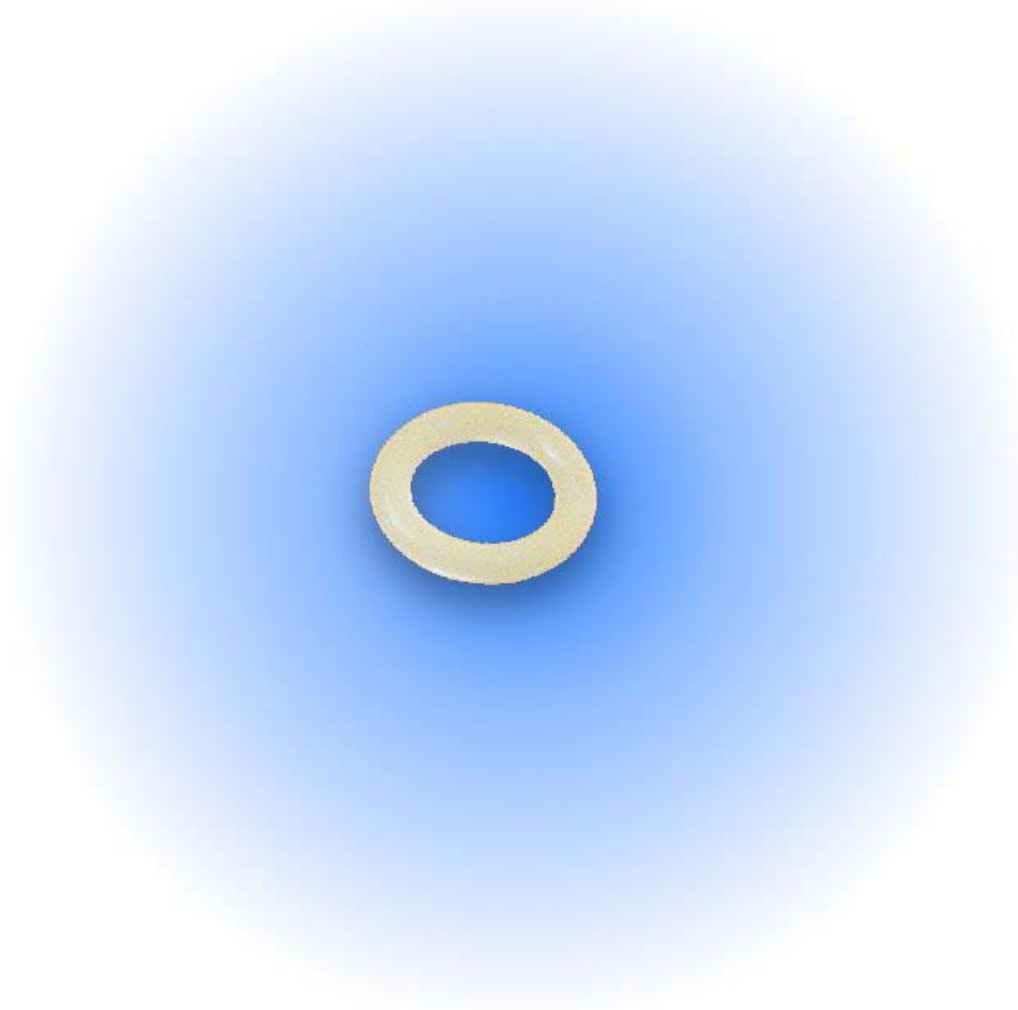

Keeps the Power Tube Tip from Loosening up.

[Order Online Now!](#)

[Back to Top](#)

## Part #683 PT Spacer Kit



The PT Spacer Kit gives you five different brass spacers all legibly numbered so you can adjust the spacing of the power tube o-ring. If your marker has bolt stick use a longer one, if it leaks down the barrel use a shorter one. Find one that works and stick with it! Quality machined brass to AGD standards. PT Spacer Kit comes with an extra power tube o-ring not shown.

[Order Online Now!](#)

[Back to Top](#)

## Part #819 Power Tube Tip Assembly



This item screws into the end of the Power Tube and is a precision part. It releases the air blast behind the ball in a controlled manner so the air hits the ball with low pressure to gently accelerate it out the barrel. Use a coin to tighten it up.

[Order Online Now!](#)

[Back to Top](#)

## Part #104 Regulator Nut



The very back of the marker has this adjustment nut to change your velocity. Made from high quality stainless steel. Use a high quality grease on the threads to reduce galling.

[Order Online Now!](#)

[Back to Top](#)

Part #684  
Reg Piston Assembly (Pre Assembled)



The Regulator Piston comes as an assembly. DO NOT take this apart. It has a built in blow off valve that will leak air if your marker becomes over pressurized. The blow off resets once your pressure goes back to normal. This safety feature is found exclusively in AGD markers. Replace the entire assembly if your marker is shooting at normal speeds and it still leaks out the back.

[Order Online Now!](#)

[Back to Top](#)



## Part #116 Regulator Seat



The Regulator Seat is the most abused part of the marker. It opens and closes with every shot and every piece of dirt in your air system eventually goes through it. To fix most velocity problems the first place to start is the Reg. Seat. Keep it clean! The seat snaps in and stays one way.

[Order Online Now!](#)

[Back to Top](#)

Part #368  
Regulator Valve Pin with Spring



This part works in conjunction with the Regulator Seat to control the air pressure in the chamber. It is not normally a wear part and should last a lifetime. Keep it clean.

[Order Online Now!](#)

Back to Top

## Part #329 Spring Pack Assembly



Not usually something that wears out. The Spring Pack comes as an assembly with all the disk springs organized in a special way. DO NOT try to take it apart! Keep it clean and lightly greased.

[Order Online Now!](#)

[Back to Top](#)

Part #225  
Z-Lock Pin



Found in the rear of the Valve Assembly this pin insures that the valve is properly assembled before placing it into the body of the marker. Needs to be pressed in.

[Order Online Now!](#)

[Back to Top](#)

Part #122  
Bumper Level 7 (Blue)

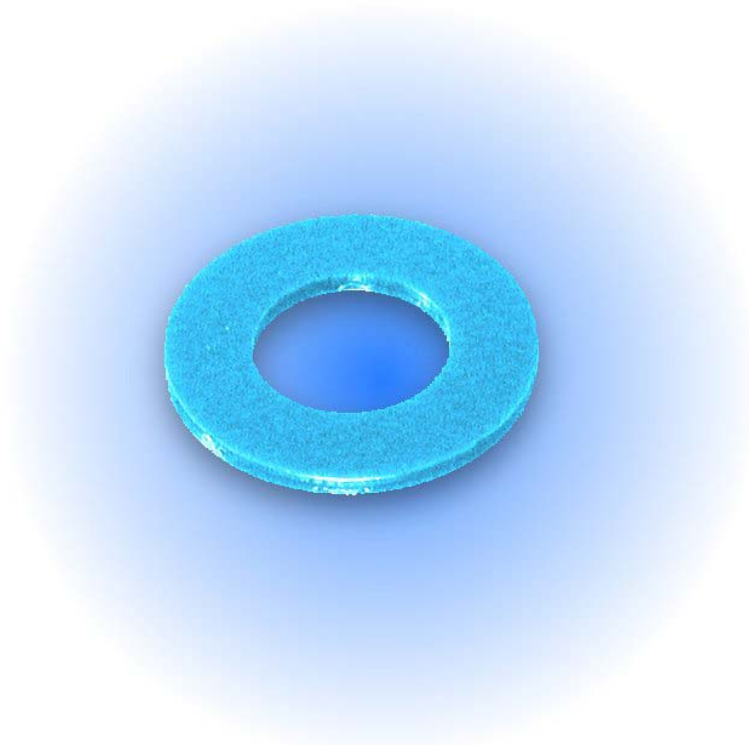

Bumpitty!! This is a urethane washer that sits at the base of your power tube. When the bolt returns, it hits this to decelerate. Not something that wears out normally. If you need one you probably lost it!

[Order Online Now!](#)

[Back to Top](#)

## Part #983 Valve Assembly Classic



Because we laser engrave matching serial numbers on each half of the Valve Assembly, you can't buy just one half of a Valve Assembly. This is a complete Valve Assembly with warranty!

[Order Online Now!](#)

[Back to Top](#)

[www.airgun.com](http://www.airgun.com)  
[www.automags.org](http://www.automags.org)  
[Airgun-UK](#)

Email to: [office@airgun.com](mailto:office@airgun.com)

**Office hours:**  
**9:00 am - 5:00 pm**  
**(Central Time)**  
**Monday through Friday**  
**Office Tel: (847) 520-7507**  
**Office Fax: (847) 520-7848**

---

**Tech Support hours:**  
**10:00 am to 11:30 am,**  
**1:00 pm - 4:00 pm**  
**(Central Time)**  
**Monday through Friday**

**Tech Support Tel:**  
**(847) 520-7225**



Back to Top