

3357 SPOTMARKER PARTS VIEW

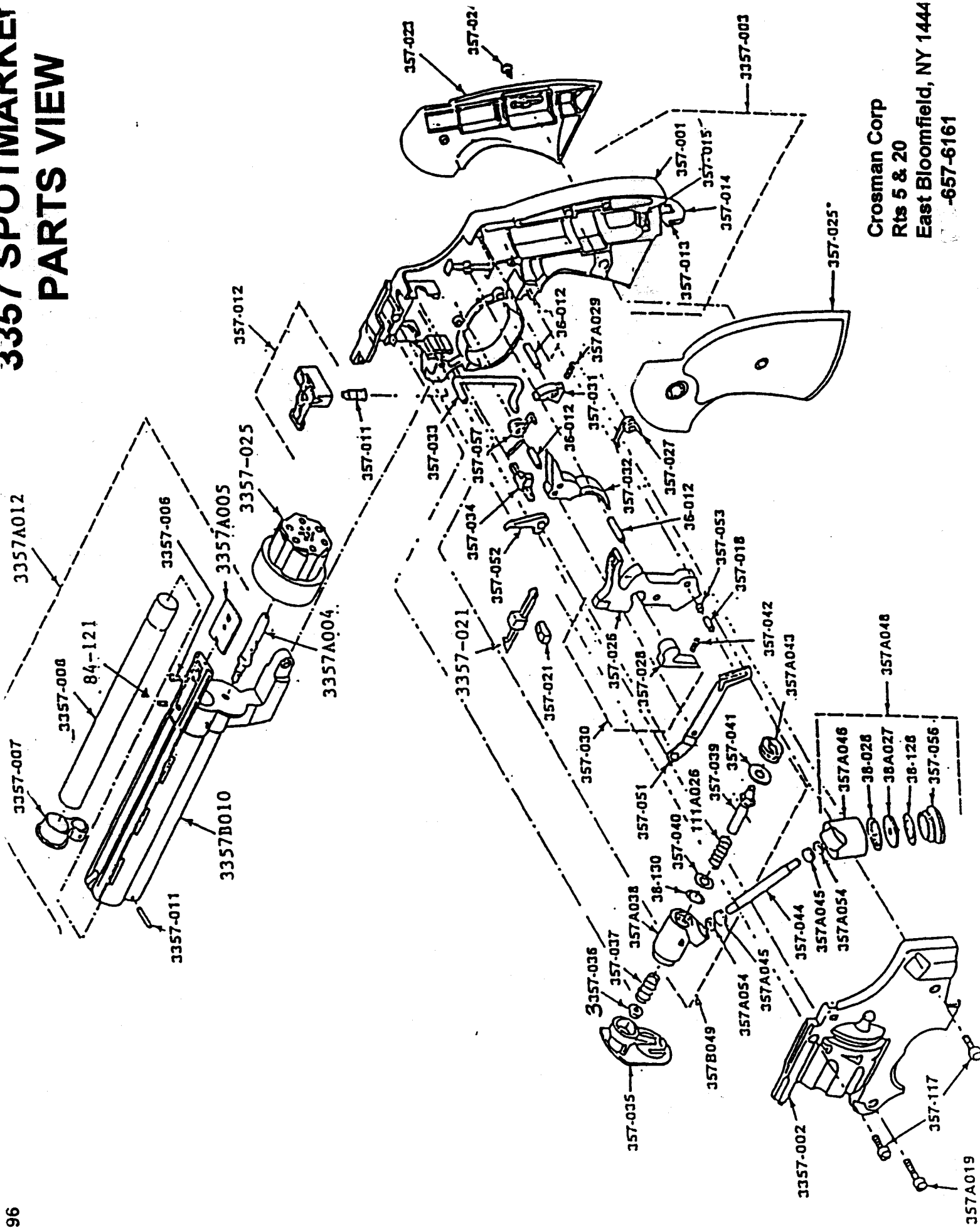

Crosman Corp
Rts 5 & 20
East Bloomfield, NY 1444
-657-6161

LIST: MODEL 3357

PARTS

PART NO	QTY	PART NAME	PART NO	QTY	PART NAME
36-012	3	PIVOT PIN	367-037	1	DETENT SPRING
38A027	1	PIERCING PIN	10841	1	VALVE BODY
38-028	1	PIERCING SCREEN	10591	1	VALVE STEM
38-117	2	FRAME SCREW	10592	1	PUCK ASSEMBLY
38-128	1	END SEAL	10802	1	VALVE ASSEMBLY
38-130	1	O RING	367-042	1	PAWL SPRING
111A028	1	VALVE SPRING	10804	1	RETAINING RING
84-121	1	SET SCREW	367A044	1	VALVE TUBE
367-011	1	ELEVATION SCREW	367C046	2	QUAD SEAL RETAINER
367-012	1	REAR SIGHT ASS'Y	367B048	1	PIERCING BODY
367-013	1	PIERCING LEVER PIN	367B048	1	PIERCING BODY ASS'Y
367-014	1	PIERCING LEVER	367-061	1	LEVER
367A016	1	PIERCING SCREW	367-062	1	INDEX FINGER
367-018	1	HAMMER/LEVER PIN	367-063	1	LEVER BUSHING
367A019	1	BARREL HOUSING SCREW	367A064	2	QUAD SEAL
367-020	1	BARREL HOUSING LATCH	367-065	1	BARREL WEIGHT 6"
367-021	1	LATCH SUPPORT	367-066	1	GUIDE COLLAR
367A022	1	GRIP, R.H. (BROWN)	367A067	1	TRIGGER SPRING
367-024	1	GRIP SCREW	3367-002	1	SIDE COVER
367A025	1	GRIP ASS'Y, L.H. (BROWN)	3367-003	1	FRAME ASS'Y
367-026	1	HAMMER	3367A004	1	SHAFT
367C027	1	HAMMER SPRING	3367A006	1	PLATE
367-028	1	HAMMER PAWL	3367A000	1	SCREW
367A029	1	SEAR SPRING	3367-007	1	PLUG
367-030	1	HAMMER ASSEMBLY	3367-008	1	BARREL
367-031	1	TRIGGER SEAR	3367B010	1	BARREL HOUSING
367-032	1	TRIGGER	3367-011	1	PIN
367-033	1	SAFETY LINK	3367A012	1	BARREL HOUSING ASS'Y
367-034 *	1	SAFETY	3367-021	1	BARREL HOUSING LATCH
367-036	1	CYLINDER PLATE	3367-025	1	CYLINDER
367-036	1	CYLINDER DETENT			

Include** 367-028

• FACTORY ASSEMBLY ONLY

used in 10602
 used in 10602
 used in 10602
 used in 10602