

**o
w
n
e
r
s

m
a
n
u
a
l**



I. SAFETY GUIDELINES



WARNING

This is not a toy. Misuse may cause serious injury or death. The user and any person within 300 yards must wear eye protection designed for paintball use. This marker is to be used by adults 18 years and older only. Obey all local, state and federal laws. Follow the rules of safe paintball marker handling. Read this users manual before use.

CONGRATULATIONS on your purchase of a Tribal paintball marker. We believe it to be the most accurate and durable paintball marker available. The Tribal will give many years of dependable service if cared for properly.

Please take the time to read through this manual thoroughly and become familiar with the Tribal parts, operation and safety precautions before you attempt to load or fire this marker.



WARNING/LIABILITY STATEMENT

This marker can be considered a dangerous weapon if mishandled, abused, or the safety instructions are ignored. The purchaser assumes all liability resulting from unsafe handling or any action that constitutes a violation of any applicable laws or regulations. Toxic Toys assumes no responsibility for physical injury or property damage resulting from the use of this weapon under any circumstances, including intentional, reckless, negligent or accidental discharges. The information in this document is subject to change without notice. TOXIC TOYS, assumes no responsibility for any errors that may appear in this document.

SAFETY

The ownership of this marker places upon you the total responsibility of its safe and lawful use. You must observe the same safety precautions as you would any firearm to insure the safety of not only yourself but also everyone around you.

- Read the entire manual before you prepare your Tribal for firing. Safety and safe marker handling are the most important aspects of paintball sports. Do not load or fire this marker until you are completely familiar with its mechanical operation and handling characteristics.
- Handle this and any other marker as if it were loaded at all times.
- Never point the marker at anything you don't intend to shoot.
- Do Not Use CO2 or any gas besides compressed air or nitrogen in your Tribal!
- Always keep the muzzle pointed down or in a safe direction, even if you stumble or fall.
- Always use a barrel plug.
- Use 0.68 caliber paintballs only in your Tribal.
- Do not field strip or disassemble this marker when it is pressurized with gas.
- Pressurize and load the marker only when the marker will be immediately used. Unload the marker and disconnect the air system immediately after use for safe storage.
- Compressed air systems can be extremely dangerous if misused or improperly handled. Use only D. O. T. certified tanks.
- Do not look directly down the barrel. Accidental discharge into the eyes may cause permanent injury or death.
- Before pressurizing your Tribal, check to make sure that you have a barrel plug in place and there is no paint in the marker.



- Dress appropriately when playing paintball. Avoid exposing any skin when playing the game of paintball. Even a light layer will absorb some of the impact and protect you from the paintballs.
- Make sure that you and everyone else within range of 300 yards is wearing A.S.T.M. approved paintball eye and ear protection in the form of goggles or full face mask, and never shoot at a person who is not similarly protected.
- Avoid shooting an opponent closer than 6 feet.

SPECIFICATIONS

Model:	Tribal Series
Caliber:	.68
Action:	Electronically Operated Pneumatics
Power:	Compressed air or nitrogen - 9V battery
Cycle Rate	13 balls per second
Standard Barrel Length	12.0"
Length-Overall	20.0"
Overall Height	9.3"
Weight (without tank)	2.65 lbs.
Effective Range	150 + ft.

II. BASIC INSTRUCTION

1. CHARGING

1-1. Installing the 9 volt Power Source

Your Tribal requires a 9-volt battery as the electronic power source.

The 9-volt battery cavity is located in the grip frame (45) beneath the side panel on the left. Remove the grip frame side panel on the left side, exposing the main electronic board (51). Place the battery into the terminal connector and place the battery in the cavity of the frame. Turn the main on-off switch (62), located on the back of the gun, to the "on" position and be sure the LED lights up, then turn it back "off." Replace the screws and the grip panel.

1-2. Your Tribal will work off either a regular 9 volt battery or the 9.6 volt rechargeable battery provided.

The 9.6 volt battery does not come charged because shipping a charged battery would wear down its lifespan. Your Tribal needs a charger to charge this battery before playing with it.

1-3 Wall and car chargers are available at local electronic stores and Wal-Marts for less than \$15. The connection port on the back of the Tribal is a standard port that almost all 9 volt charges will have. Polarity should be set with the tip of the plug to + and the base of the plug to -.

1-4 To charge the battery, connect the 9.6 volt battery in the gun. Plug the charger into the back of the gun and plug it into the wall or your car. The gun does not have to be "on" to charge the battery. Leave the battery charging for 8 hours for the first charge. Your Tribal may remain charging for longer than overnight without damaging the gun or the battery.



WARNING:

Be sure that the marker is switched "off" before adjusting settings or the air pressure for your marker. Check to make sure the TRIBAL is switched "off."





2. AIR SUPPLY

The Tribal should only be used with compressed air or nitrogen. Do not use CO2 with your Tribal or the warranty is void. Before installing air source - check to make sure the TRIBAL is switched "off."

- 2-2. Make sure eye protection is worn.
- 2-3. Only use a regulator which has been designed for use with a TRIBAL.
- 2-4. Set your input pressure between 800 and 850 p.s.i.

3. SWITCH SETTING - MODES - RATE OF FIRE

Shooting Time adjusts your shots per second. More shots per second means a higher potential for chopping paint if you shoot faster than your loader can feed.

Exhaust Valve Time determines how long the valve is open. Shorter dwell time increases the Tribal's shot count per bottle and makes less noise. Longer dwell time makes the gun shoot louder and consume more gas but it increases your Tribal's ability to handle poor and brittle paint. Adjustment should only be made by a qualified airsmith. Always recheck velocity after adjusting dwell time.

MODEL 8 SWITCHES



Exhaust Valve Opening Time

Switches	#1	#2	#3	Time /ms/
	Off	Off	Off	14
	off	Off	On	15
	off	On	Off	16
	off	On	On	17
	on	Off	Off	18
	on	Off	On	19
	on	On	Off	20
	on	On	On	21

Shooting Time

Switches	#4	#5	#6	Shots per second
	Off	Off	Off	13
	Off	Off	On	12
	Off	On	Off	11
	Off	On	On	10
	On	Off	Off	9
	On	Off	On	8
	On	On	Off	7
	On	On	On	6

Shooting Modes

Switches	#7	#8	Action
	Off	Off	1 /one single shot per trigger pull/
	Off	On	3 /three shots per trigger pull/
	On	Off	6 /six shots per trigger pull/
	On	On	Full auto





MODEL 6 SWITCHES



Exhaust Valve opening time

Switches	#1	Time /ms/
	Off	17
	On	18

Shooting Time

Switches	#2	#3	#4	Shots per second
	Off	Off	Off	13
	Off	Off	On	12
	Off	On	Off	11
	Off	On	On	10
	On	Off	Off	9
	On	Off	On	8
	On	On	Off	7
On	On	On	6	

Shooting modes

Switches	#5	#6	Action
	Off	Off	1 /one single shot per trigger pull/
	Off	On	3 /three shots per trigger pull/
	On	Off	6 /six shots per trigger pull/
	On	On	Full auto

4. FIRING YOUR TRIBAL

Keep your finger out of the trigger guard and away from the trigger and point the muzzle of your marker in a safe direction at all times before you are ready to fire.. Be sure your goggles are securely in place. Make sure the on-off switch is in the "off" position.

ALWAYS KEEP YOUR TRIBAL POINTED IN A SAFE DIRECTION!

- 4-1. Place the empty loader into the marker. Be sure that it is securely mounted in place. Remember that the vertical feed screws into the gun. Always spin the loader in a clockwise direction when putting the loader on or taking it off.
- 4-2. Apply compressed air or nitrogen, pressurizing the gun.
- 4-3. Put the paintballs into the loader.
- 4-4. Aim the marker at the target.
- 4-5. Push the on-off switch to the "on" position, the LED will light up.
- 4-6. Place your finger on the trigger.
- 4-7. Pull the trigger with a smooth squeezing motion.





III. MAINTENANCE

SIMPLE MAINTENANCE

Keep your Tribal clean and lubricated to eliminate the friction that would prevent reliable operation. Clean and lube the marker before each use, and do not put it away dirty. It is important to lube the bolt each time you play. It's recommended to lube and clean the Pneumatic cylinder and AOC once a month, also it is recommended to lube the vertical regulator every two months:

- Cleaning Paint from the Barrel
 1. Unscrew the barrel (1) and remove it for swabbing/cleaning. Keep the barrel clean to ensure the continued accuracy of your Tribal. Gelatin from paintballs has a tendency to build up in the barrel. Wash out the barrel with hot soapy water and rinse it well.
- Removing the Bolt Assembly
 1. Remove the paint and pressurized gas from the marker. This marker can be field stripped while it is pressurized.
Remove (pull) the cocking handle (6) from the top of the marker. Pull the bolt (7) out from the back of the main body.
- Pneumatic cylinder
 1. Unscrew body/body back cap screw (61), remove body back cap (60), gently remove body back electronic board (55) and unscrew pneumatic cylinder, using the 2 pin key (12).
 2. Cylinder body has 8 peripheral holes, put silicone grease in it and move the pneumatic cylinder plunger (17) back and forth several times.
- AOC
 1. Remove the AOC cap (31) using the 2 pin key (12) and lube the AOC plunger O-ring (30), using thin oil (like PMI Perfect Gun Oil).
Do not use petroleum-based lubricants for the lubrication of this gun.
- Exhaust valve
 1. Unscrew the body AOC cap (31) using the two pin key (65).
 2. Unscrew the vertical regulator and vertical adapter screw (65).
 3. Extract the AOC plunger (29), using AOC plunger extractor (79) by screwing it in the front thread of the AOC plunger and pulling it out.
 4. Pull out the AOC body (26), using the optional AOC body extractor (78) by inserting the extractor's tip into the front hole of the body (26) pressing it downward and pulling it out.

Once the bolt assembly is removed, it is possible to clean the entire upper receiver of the marker, including the breech and feed tube area. You may slightly lubricate the rear section of the bolt and bolt chamber with thin oil or spray lubricant before reinstalling the bolt. Point the barrel downward and slide the bolt in until the cocking handle hole lines up with the slot in the hammer (18) and install the cocking handle (6).



TRANSPORTATION AND STORAGE:

- Your Tribal must be clear of all paint and disconnected from its air source when not being used.
- Be sure the on-off switch is "off" and the LED is not lit.
- Put the barrel plug in place.
- Make sure the marker is clean.
- Store your Tribal in a clean, cool and dry place.
- Keep your Tribal away from children.



THIS MARKER IS NOT A TOY!
TO BE USED BY ADULTS ONLY!

Your Tribal must be clear of all paint and any source of propellant during transportation to and from the playing field. Keep your barrel plug in place. Keep the on-off switch "off." Protect your Tribal from excessive heat during transportation. Observe and obey all local, state and federal laws concerning the transportation of a paintball marker. For information concerning any of the laws in your area, contact your friendly nearby law enforcement agency.

IMPORTANT:

Never carry your Tribal uncased when not on a playing field. The non-playing public and law enforcement personnel may not be able to distinguish between a paintball marker and a firearm. For your own safety and to protect the image of the sport, always carry your Tribal in a suitable case or in the box in which it was shipped. If you must ship your Tribal for any reason, the box in which you purchased the marker is acceptable to all major carriers. Never ship charged compressed air or pressurized gas containers.





V. DISASSEMBLY OF THE MARKER

It is not recommended that you disassemble your Tribal unless you are a trained air-smith. Damage done to the marker due to untrained removal of parts will void your warranty.



1. Turn the on - off switch (# 62) to "off."



2. Pull out the Cocking handle (# 6).

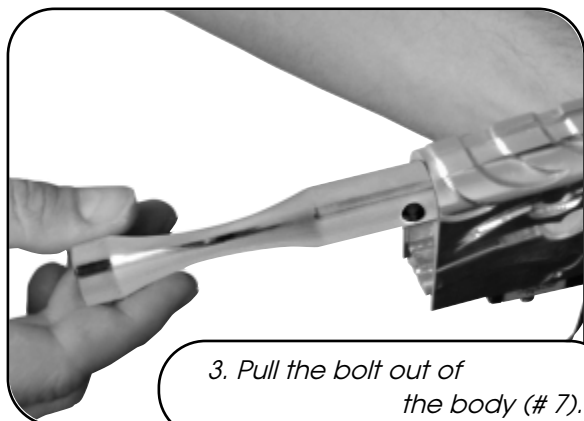

3. Pull the bolt out of the body (# 7).

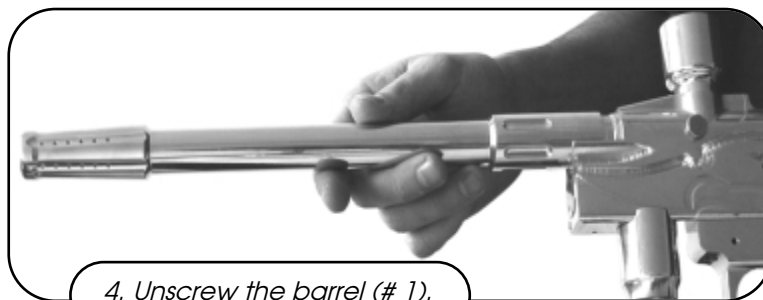

4. Unscrew the barrel (# 1).

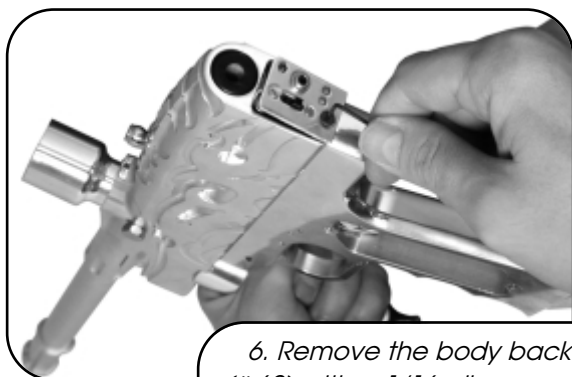

6. Remove the body back cap (# 60) with a 1/16 allen wrench.



5. Remove the grips from the frame (# 45).



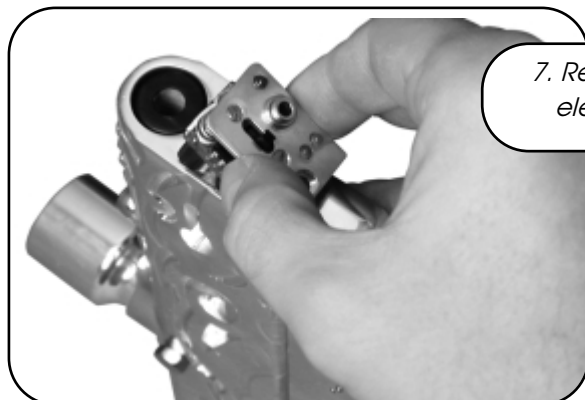

7. Remove body back electronic board (# 55).



8. Remove the frame (# 45) with a 5/32 allen wrench.

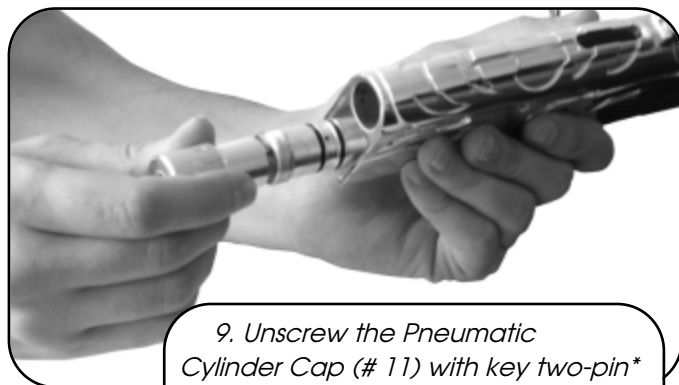

9. Unscrew the Pneumatic Cylinder Cap (# 11) with key two-pin* (# 12) and pull out the Pneumatic Cylinder

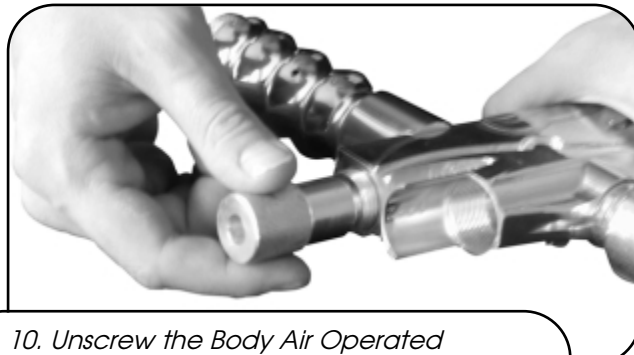

10. Unscrew the Body Air Operated Controller Cap (#31) using key two-pin (# 12).

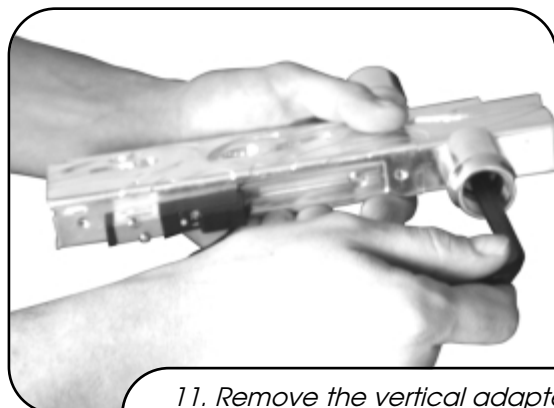

11. Remove the vertical adapter body (# 64) by unscrewing vertical adapter screw (# 65) with a 5/16 allen wrench.



12. Pull out the controller plunger (# 29), using AOC extractor* (# 78) (screw it in the front thread of the AOC plunger and pull it out).





13. Pull out AOC spring (# 28).



14. Pull out the AOC body (# 26), using AOC body extractor (# 78)* (insert the extractor's tip into the front whole of the body (# 26) press it downward and pull it out).



15. Unscrew valve guide body screw (# 34). Pull out the exhaust valve (# 19).

* Tools sold separately

V. ADJUSTMENT.

1. CHRONOGRAPHING YOUR TRIBAL.

- Shoot your Tribal flat over the chronograph to insure an accurate reading.
- If your velocity is over the field limit, turn the adjustment screw (74) in the vertical regulator clockwise.
- If your velocity is too low, turn the adjustment screw (74) in the vertical regulator counter-clockwise.
- Small turns will make a big difference in your velocity.
- Shoot the gun three times to set the regulator.
- Make sure you never shoot your Tribal over 300 feet per second.

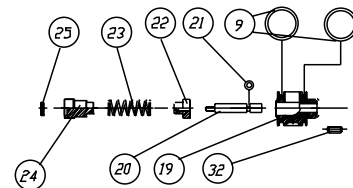

- 9. Pneumatic Cylinder body/ Valve Guide Body/ Vertical Adapter Body/ Head Cap/ Air Operated Controller Body/ Down Regulator Body/ Down Cap "O"-Ring
- 19. Valve Guide
- 20. Exhaust Valve Guide
- 21. Exhaust Valve Guide "O"-Ring
- 22. Exhaust Valve Guide Cap
- 23. Valve Guide Spring
- 24. Air Operated Controller Cap
- 25. Disk
- 32. Plug Cap Large Size Screw



2. AIR OPERATED CONTROLLER (LOW PRESSURE REGULATOR) ADJUSTMENT.

It is not recommended that you adjust the AOC by yourself. Operating pressure of the AOC is 100 - 130 p.s.i. which is adjusted by the manufacturer. Pressure level is adjustable through Air Operated Controller Cap (24) which is also set by the manufacturer. If you loosen it the pressure becomes higher. This process requires special tools that are not included with the gun. Please refer to authorized services at www.paintball-tribal.com.

AOC adjustment:

- Unscrew the body AOC cap (31) using the two pin key (65), vertical regulator and vertical adapter screw (65), extract the AOC plunger (29), using AOC plunger extractor (79) (screw it in the front thread of the AOC plunger and pull it out). Pull out the AOC body (26), using the optional AOC body extractor (78) (insert the extractor's tip into the front hole of the body (26) press it downward and pull it out).
- Adjust the AOC cap (24) using a flathead screw driver. If you turn it counter-clockwise the pressure becomes higher. Mount the AOC vertical adapter and vertical regulator.
- Screw in AOC adjusting device (81) and AOC cap (31).
- Screw in optional gauge (13) in the back thread of AOC adjusting device (81) and connect air container with the vertical regulator.
- Switch on the marker and shoot twice.
- Check the pressure (100 - 130 PSI needed).
- If the pressure is not right, disconnect air supply, shoot once, switch "off" the marker, unscrew AOC adjusting device (81) and repeat step "b" to step "f".
- If the pressure is right disconnect the air container, shoot once (to discharge the marker) and switch the marker "off." Unscrew the gauge and AOC adjusting device (81) and screw it into the body AOC cap (31) instead.

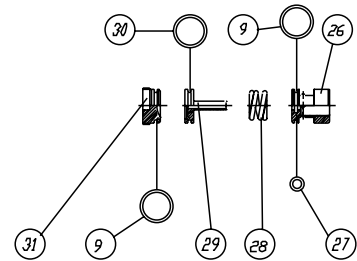

9. Pneumatic Cylinder body/ Valve Guide Body/ Vertical Adapter Body/ Head Cap/ Air Operated Controller Body/ Down Regulator Body/ Down Cap "O"-Ring
 26. Air Operated Controller Body
 27. Air Operated Controller Body Inside "O"-Ring
 28. Air Operated Controller Spring
 29. Air Operated Controller Plunger
 30. Body/ Air Operated Controller Plunger "O"-Ring
 31. Body/ Air Operated Controller Cap

3. HIGH PRESSURE REGULATOR (HPR) - VELOCITY ADJUSTMENT.

Operating pressure of the HPR is 300 - 350 p.s.i. and adjusts the velocity of the paintball. The regulator comes adjusted by the manufacturer. Adjustment is done through the adjusting screw (74) on the side of the vertical regulator. Use a chronograph to make sure your Tribal never shoots above 300 f.p.s. For dramatic changes, follow the steps below to make sure your marker is shooting at optimum performance.

- Remove the vertical regulator.
- Screw in optional vertical regulator adjusting device (80) in the vertical adapter (64).
- Attach optional gauge to the suitable side thread hole of the vertical regulator adjusting device (80).
- Screw the vertical regulator into vertical regulator adjusting device (80).

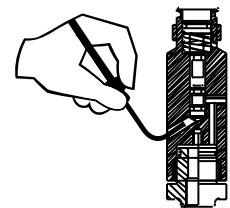



- e) Connect the air supply.
- f) Switch the marker "on."
- g) Shoot once or twice.
- h) Adjust the vertical regulator through the adjusting screw (75). If your pressure is too low, turn the adjustment screw (74) in the vertical regulator counter-clockwise. Small turns will make a big difference in your pressure.
- i) Shoot once and check the pressure (300 - 350 p.s.i.).
- j) If the pressure is not correct repeat step "h" and "i."
- k) If the pressure is correct - disconnect air supply, shoot once (to discharge the marker), switch off the marker, remove vertical regulator adjusting device (80) and screw vertical regulator into the vertical adapter.

4. PNEUMATIC CYLINDER (14) MAINTENANCE

- check every 100,000 shots. O-rings (15 and 16)- clean them or replace them if they are worn or torn.
- Refer to chapter III.

5. LEAKAGE PROBLEMS.

Your Tribal has a leak around the vertical regulator seal.

Reason: *the seal between the vertical regulator body and the main body is bad or the regulator has come loose.*

- a) Tighten the regulator into the body (2).
- b) Check and replace the o-ring (9) - sized 015 if needed.

Your Tribal has a leak around the AOC seal.

Reason: *the seal between the regulator cap (31) and the main body (2) is bad or the regulator has come loose.*

- a) Tighten the regulator cap (31) into the body (2).
- b) Check and replace the o-ring (9) sized - 015 if needed.

Your Tribal has a leak inside the grip/battery area.

Reason: *the 4-way valve (35) is leaking through the manifold.*

- a) Tighten the 4-way valve screws (36).
- b) Check for over-pressurization from the AOC (26).
(Refer to V.2 above)
- c) Replace the o-rings on the cylinder assembly (9). Sized - 015.
- d) Replace the piston o-ring (16). Sized - 011.
- e) Replace the solenoid/valve assembly (35).



6. BALL BREAKAGE PROBLEMS.

- a) The balls in your loader can bind, affecting up the marker's ability to feed. Note: use an agitating loader for best results.
- b) As you run and shoot, you actually bounce the gravity-fed balls in your loader. This can cause a ball to hesitate in its drop. This affects how well the balls feed.
- c) If the ball retainer (3) does not move freely, the paintballs will crush against it or it may stick in the depressed position allowing the marker to double feed. Check its tension regularly and keep this area as clean as possible.
- d) If the ball retainer (3) is too sloppy, the ball will not be held in the proper position. This may allow the next ball to enter the path of the bolt, subjecting it to impact, cracking or shearing. Verify the tension by pushing on the ball retainer to make sure it still springs back if ball breakage becomes a problem.
- e) Increasing the on time of the solenoid (35) will decrease possible blowback that is created when the ball is expelled. (refer to II.3 above)

7. IF THE INDICATION LED DOES NOT WORK AND THE MARKER DOES NOT OPERATE:

1. Check if the battery is charged.
2. If the battery is charged refer to authorized service at www.tribal-paintball.com.

VI. BATTERY INDICATION:

1. Green light - battery is charged, the marker is ready to be used.
2. Yellow light - battery is weak, the marker still can be used.
3. Red light - battery is low, recharge.



VII. ALLEN WRENCHES AND O RINGS SET

ALLEN WRENCHES:

- I. Down regulator
 1. Down regulator adjusting screw- 5/64 allen wrench
 2. Vertical adapter screw- 5/16 allen wrench
- II Main electronic board
 1. Main electronic board/frame screw-3/32 allen wrench
- III. Bottom line
 1. Bottom line small and large screw- 5/32 allen wrench
- IV.Frame
 1. Body frame screws- 5/32 allen wrench
- V. Body back cap
 1. Body/Body back cap screw- 1/16 allen wrench
- VI.Trigger
 1. Trigger screw 0.05 allen wrench
 2. Frame- trigger adjuster screw- 0.05 allen wrench

"O" RINGS:	O ring size	O ring material	Quantity
<i>I. Down regulator</i>			
1. Down regulator plunger large O ring	012	Poly uretan	1
2. Down regulator plunger small O ring	006	Poly uretan	1
3. Down regulator exhaust valve O ring	006	Buna M	2
4. Down regulator retaining O ring	015	Buna M	1
5. Down regulator down cap O ring	015	Buna M	1
<i>II. Air operated controller</i>			
1.Body AOC plunger O ring	015	Poly uretan	1
2.AOC body inside O ring	008	Poly uretan	1
3.AOC body O ring	015	Buna M	2
4.AOC head cap O ring	015	Buna M	1
<i>III. Exhaust valve</i>			
1. Exhaust valve guide O ring	003	Buna M	1
2. Valve guide O ring	015	Buna M	1
<i>IV. Pneumatic cylinder</i>			
1. Pneumatic cylinder body O ring	015	Buna M	3
2. Pneumatic cylinder body inside O ring	010	Poly uretan	1
3. Pneumatic cylinder cap outside O ring	010	Buna M	1
4. Pneumatic cylinder plunger O ring	011	Poly uretan	1
<i>V. Vertical adapter</i>			
1. Vertical adapter body O ring	015	Buna M	1



VII. WARRANTY INFORMATION

Congratulations on the purchase of your new Tribal. Toxic Toys takes pride in manufacturing high quality products for the entire paintball playing public. We hope that you experience many years of trouble free enjoyment from using your Tribal. We have gone to great lengths to engineer and produce this product to be extremely durable and reliable. Should you experience difficulty in operating any Toxic Toys product, please reread the owner's manual carefully to insure you are operating the product properly. If you are unsuccessful, Toxic Toys will attempt to solve your problem.

Toxic Toys warrants to the original purchaser that this product is free from defects in material and workmanship under normal use and service for a period of one year from the date of purchase. For this warranty to be effective, customer must return the enclosed Tribal warranty information form, filled out in its entirety. A copy of the original purchase receipt must accompany the warranty card when you send it in, or when presenting the product to a Tribal authorized store or gamefield for repairs.

Toxic Toys agrees to repair or replace (at its sole discretion) any product within a reasonable period of time, providing that it is returned with postage prepaid to Toxic Toys. This warranty does not cover:

- Abuse from user.
- After-market products added to the product.
- O-rings.
- Scratches.
- Modifications to the product.
- Normal wear and tear of moving parts.
- Normal fading of anodized finish.
- Damage caused in shipping due to poor packing from customer to Tribal.
- Removal of electronic board from frame.

This warranty covers original factory parts only, and any modification or tampering to any original factory part will void this warranty.

If your Tribal is still under warranty and in need of repair, you can take it to the store or gamefield from which you originally purchased, or pack carefully, and send it with the following information, to the address below.

1. Copy of the original purchase receipt showing the date of purchase.
2. Complete description of the malfunction.
3. Your name, address, and daytime phone number.

If your Tribal is out of warranty please contact Toxic Toys for the name of your nearest authorized gamefield or store. They will attempt to evaluate your problem and make the necessary repair at the current shop rate.

Ship to Address:

Toxic Toys

104 W. Chestnut St. Unit 314

Hinsdale, IL 60521

Toll Free: 877-787-4225

Tel: 630-782-0764

Fax: 630-782-1932



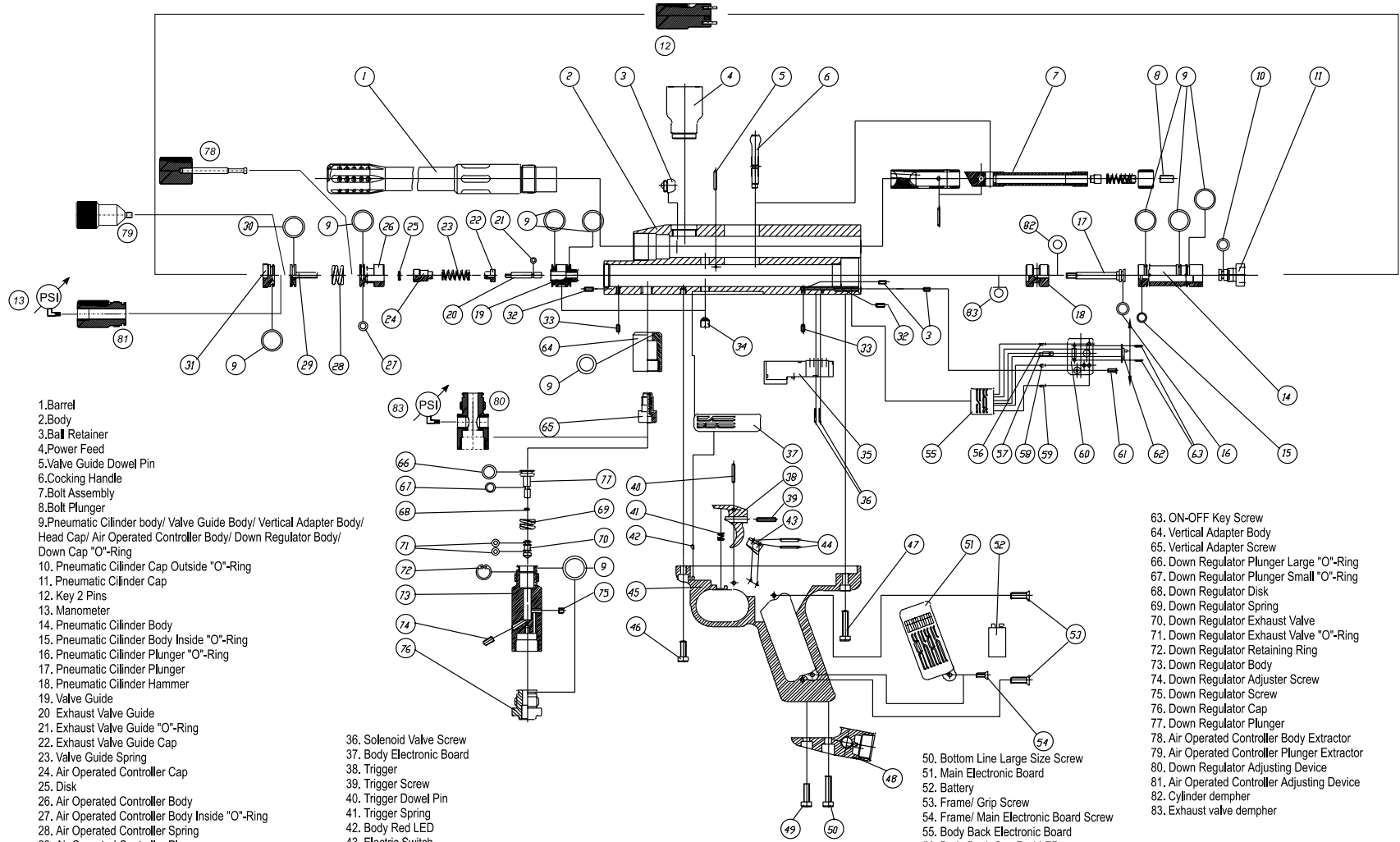

- 1.Barrel
- 2.Body
- 3.Ball Retainer
- 4.Power Feed
- 5.Valve Guide Dowel Pin
- 6.Cocking Handle
- 7.Bolt Assembly
- 8.Bolt Plunger
- 9.Pneumatic Cilinder body/ Valve Guide Body/ Vertical Adapter Body/ Head Cap/ Air Operated Controller Body/ Down Regulator Body/ Down Cap "O"-Ring
- 10. Pneumatic Cilinder Cap Outside "O"-Ring
- 11. Pneumatic Cilinder Cap
- 12. Key 2 Pins
- 13. Manometer
- 14. Pneumatic Cilinder Body
- 15. Pneumatic Cilinder Body Inside "O"-Ring
- 16. Pneumatic Cilinder Plunger "O"-Ring
- 17. Pneumatic Cilinder Plunger
- 18. Pneumatic Cilinder Hammer
- 19. Valve Guide
- 20 Exhaust Valve Guide
- 21. Exhaust Valve Guide "O"-Ring
- 22. Exhaust Valve Guide Cap
- 23. Valve Guide Spring
- 24. Air Operated Controller Cap
- 25. Disk
- 26. Air Operated Controller Body
- 27. Air Operated Controller Body Inside "O"-Ring
- 28. Air Operated Controller Spring
- 29. Air Operated Controller Plunger
- 30. Body/ Air Operated Controller Plunger "O"-Ring
- 31. Body/ Air Operated Controller Cap
- 32. Plug Cap Large Size Screw
- 33. Plug Cap Small Size Screw
- 34. Body/ Valve Guide Body Screw
- 35. Solenoid Valve
- 36. Solenoid Valve Screw
- 37. Body Electronic Board
- 38. Trigger
- 39. Trigger Screw
- 40. Trigger Dowel Pin
- 41. Trigger Spring
- 42. Body Red LED
- 43. Electric Switch
- 44. Electric Switch Dowel Pin
- 45. Frame
- 46. Body/ Frame Small Size Screw
- 47. Body/ frame Large Size Screw
- 48. Bottom Line
- 49. Bottom Line Small Size Screw

- 63. ON-OFF Key Screw
- 64. Vertical Adapter Body
- 65. Vertical Adapter Screw
- 66. Down Regulator Plunger Large "O"-Ring
- 67. Down Regulator Plunger Small "O"-Ring
- 68. Down Regulator Disk
- 69. Down Regulator Spring
- 70. Down Regulator Exhaust Valve
- 71. Down Regulator Exhaust Valve "O"-Ring
- 72. Down Regulator Retaining Ring
- 73. Down Regulator Body
- 74. Down Regulator Adjuster Screw
- 75. Down Regulator Screw
- 76. Down Regulator Cap
- 77. Down Regulator Plunger
- 78. Air Operated Controller Body Extractor
- 79. Air Operated Controller Plunger Extractor
- 80. Down Regulator Adjusting Device
- 81. Air Operated Controller Adjusting Device
- 82. Cylinder dempfer
- 83. Exhaust valve dempfer
- 50. Bottom Line Large Size Screw
- 51. Main Electronic Board
- 52. Battery
- 53. Frame/ Grip Screw
- 54. Frame/ Main Electronic Board Screw
- 55. Body Back Electronic Board
- 56. Body Back Cap Red LED
- 57. Body Back Cap Electric Jack
- 58. Body Back Cap Yellow LED
- 59. Body Back Cap Green LED
- 60. Body Back Cap
- 61. Body/ Body Back Cap Screw
- 62. ON-OFF Key



www.paintball-tribal.com